

# AR51A GEKKO WAND PARTS

Part #	Description	QTY
AR51A	Handle Gekko Wand Complete	1
NA030	Weldment Handle Gekko Wand	1
NM5855	Gekko Tool Connector Assembly	1
NA030A	Vent Slide, Handle, Gekko	1
NM4080	10-32 x 1 5/8" Screw	3
NM4028	10-32 Hex Nut Zinc Plated	3
100010	Spray Gun Handle (Modified)	1
AH102B	1/4" Male Quick Connect	1
NA0802	1/4" Strainer Body	1
NA0803	Mesh Strainer	1
NA0804	Brass Strainer Adapter	1
BR272	1/4" 45° Elbow M-F	1
BR282	1/4" 90° Elbow M-F	1
NM5856	Gekko Wand Solution Hose Assembly (44" – 1/4" MPT ends)	1
AH101B	1/4" Female Quick Connect Brass	1
NA5863	Gekko Hose Strap - Velcro	2
NM5858	Gekko Grip Handle Assembly (Includes Mounting screws & nuts)	1
LB85	Decal Gekko	1

# AR51A GEKKO WAND PARTS



NM5856 Gekko Wand solution hose assembly:  
44" - High Pressure 3/16" Solution Hose with 1/4" MPT ends



# AR51A GEKKO WAND PARTS



BR272



BR282



NA0804



NA0803



NA0802



AH102B

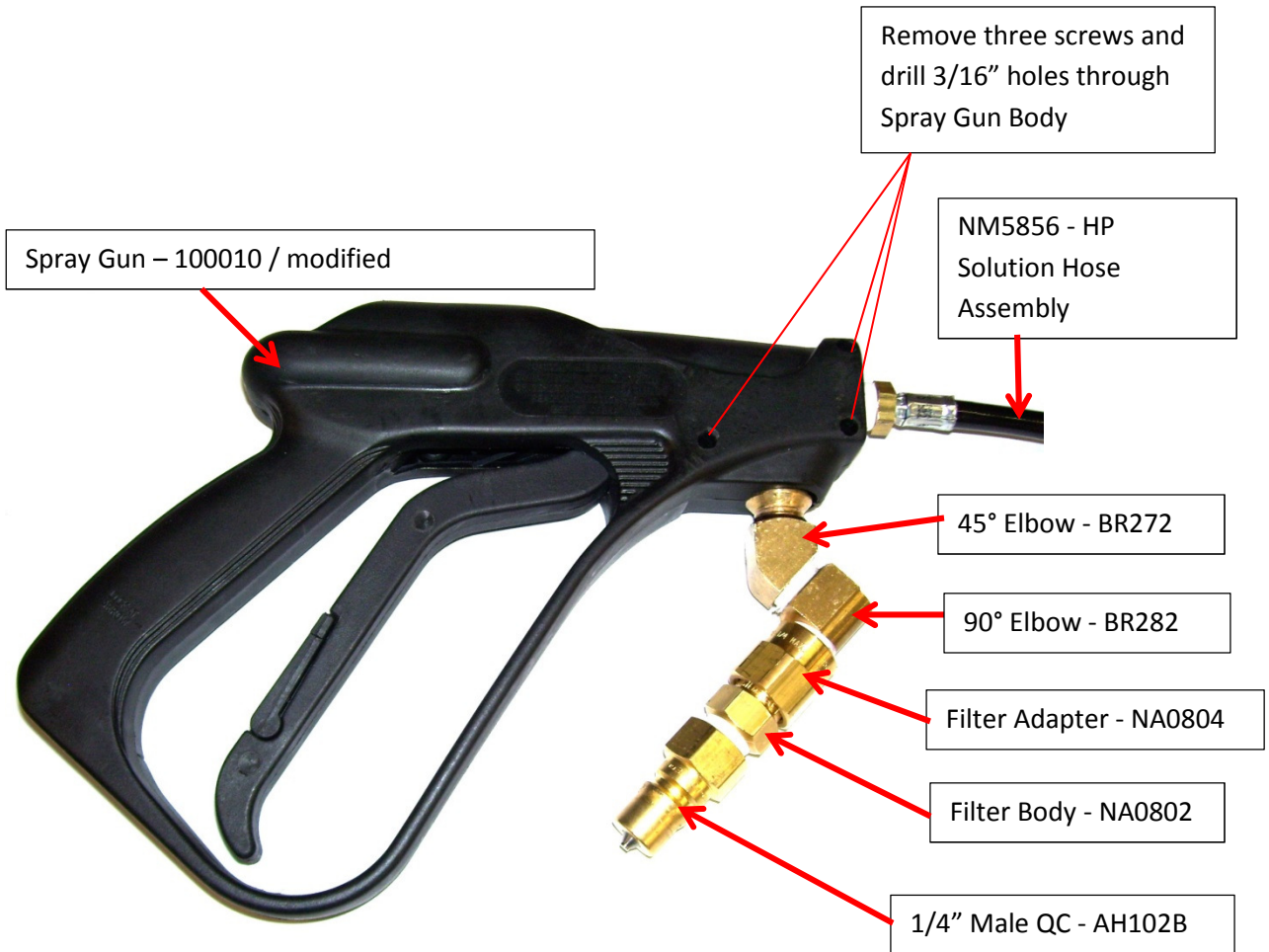

# AR51A GEKKO WAND PARTS

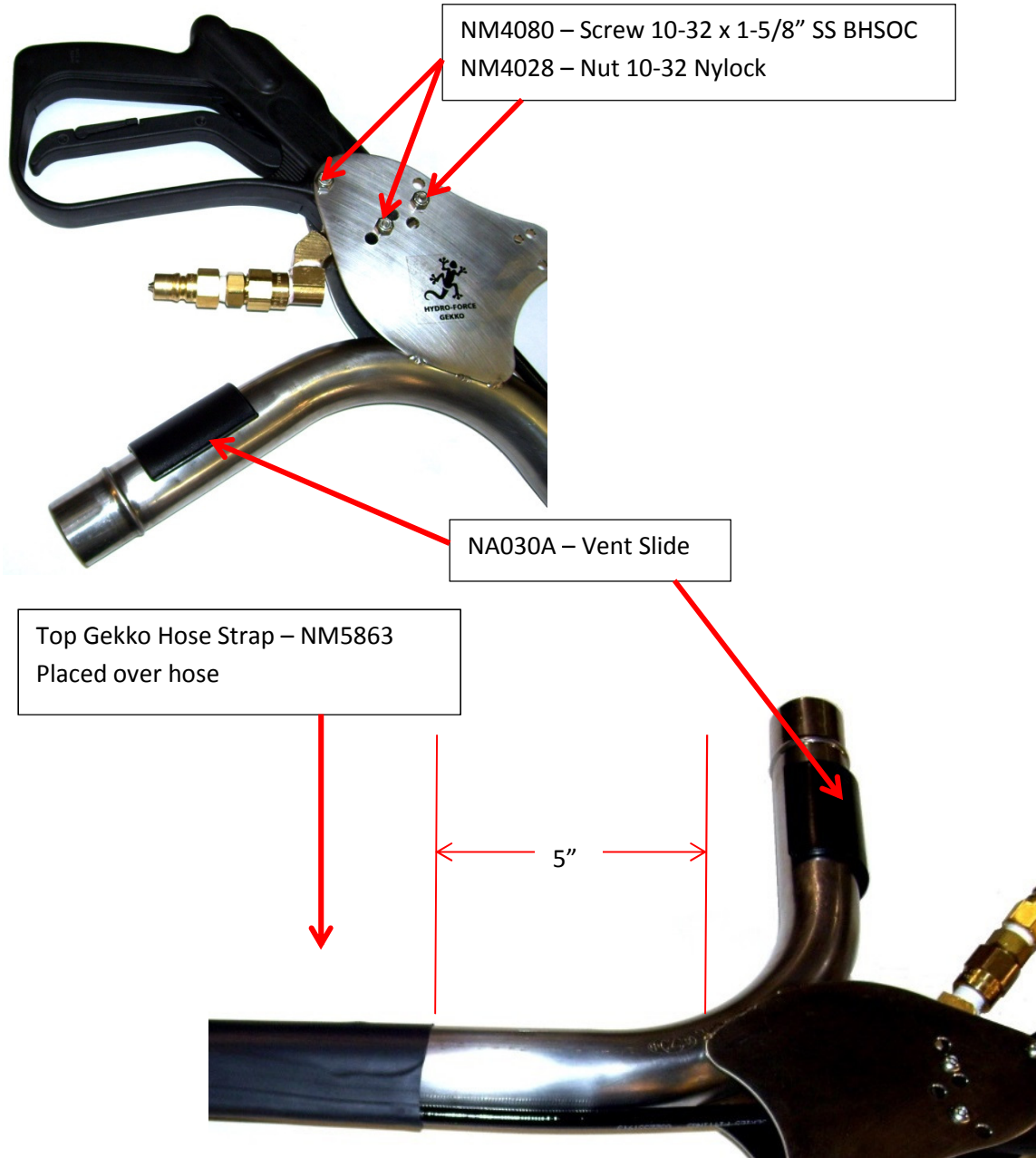

# AR51A GEKKO WAND PARTS

## Coupler Assembly NM5855

Includes both sides of coupler & two screws

APPLY GREASE HERE

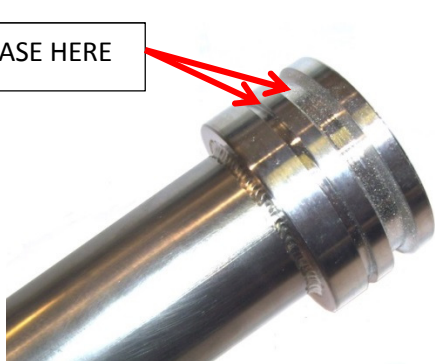

Left Coupler



Right Coupler



8-32 X 7/16" SS Phillips Pan Head Screws



Gekko Tool Coupler Assembly Installed on Wand Tube  
(Apply Loctite 242 Medium Thread Locker to screws)

Bottom Gekko Hose Strap – NM5863 placed over Hose

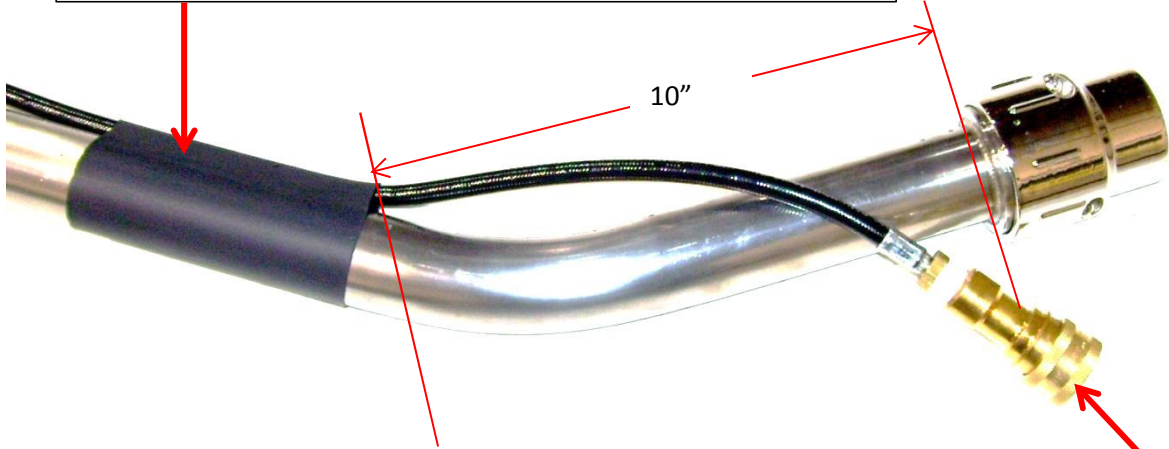

1/4" Female QC - AH101B

# AR51A GEKKO WAND PARTS

Gekko Decal - LB85 only on right side of Gekko Bracket

