



**Description**      **HydroForce Modular Van Shelf - Complete**  
**Item #**              **2648-6593**  
**PID**                  **269458**

The HydroForce Modular Van Shelf offers the ultimate in flexibility and versatility when compared to other modular systems. This system fits in virtually any van and allows for adjustments not available with other units. The individual shelves of the HydroForce Modular System can be adjusted to fit closer to the van wall, or further away based on the contractor's needs, type of vehicle or type of installation. In addition, the shelves can be adjusted up or down to ensure they are always level, regardless of the install. Many competitive units are unlevel as they only follow the angle of the van body, or the base is moved further out into the van floor, eating up valuable space.

The HydroForce Modular Shelf also includes some unique hardware pieces that ensure a solid, safe and secure installation that will hold up to the rigors of everyday use and / or vibration issues a vehicle can experience during travel.

Features of the HydroForce Modular Van Shelf:

- Shelves are made from Stainless Steel while vertical posts and cross members are made from aluminum, offering an excellent combination of strength, durability and corrosion resistance.
- Shelves are 47" W x 7" D x 4" H and hold seven (7) standard gallon bottles.
- Shelves can adjust several inches in or out away from wall as well as tilt up or down to ensure a level mount and to maximize storage efficiency.
- Unique hardware such as heavy-duty angle brackets and self-aligning T-slot nuts provide a secure and stable mount.
- Watch for future attachable accessories coming for enhanced tool storage.

# Van Wall Assembly



# VW MOUNT

2X 2649-6897 VAN WALL SHELF HORIZONTAL

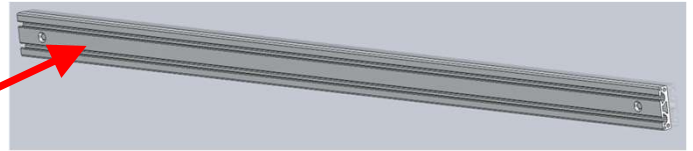

THIS HARDWARE BAG



Locate where to attach Van Wall Shelf Assembly.

VW MOUNTs should be horizontal between structural pillars on the vehicle. Mounts should be spaced between 3 to 4 feet vertically from one another.

Once mounting location is identified with sufficient structure, identify corresponding location for attaching VW MOUNTs.

Drill holes in VW MOUNTs to mount on van holes to be between 13/32" and 7/16" diameter. These holes are to be in the centered or 1-1/2" from the edge; and no closer than 1-1/4" from the ends. Holes are to be countersunk no deeper than needed for the screw head to be flush on the surface.

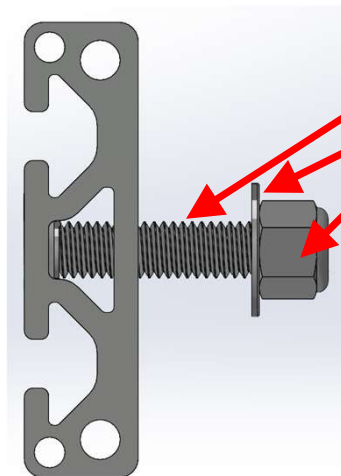
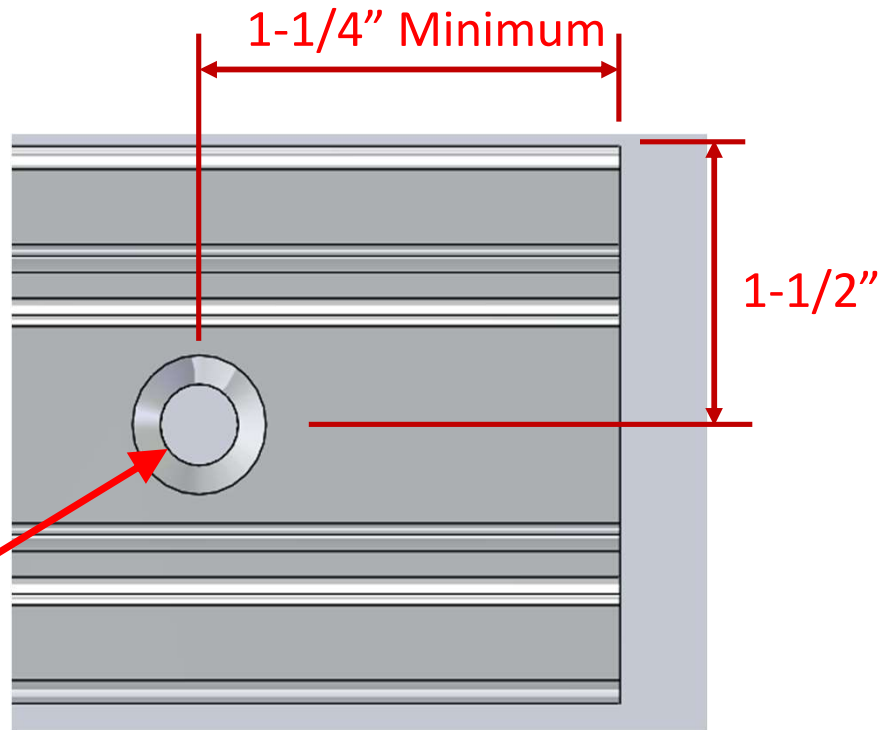

Mount the VW Mounts using

4X 2651-6599 PHILLIPS FLAT HEAD SCREW 3/8-16 X 2 SS

4X 2653-6591 3/8 FLAT WASHER SS

4X 1692-2407 NYLOC NUT 3/8-16 SS

## Attach Angle Brackets



THIS HARDWARE BAG



Note: 2657-6494 SELF ALIGNING NUT is inserted into the T-slot by inserting sideways through the T opening and rotated with a pick or small screwdriver into position. The spring will hold it in position. But it can be slid along the T track to location needed. To remove the nut, reverse the process by rotating and sliding out sideways.



# Attach Angle Brackets



THIS HARDWARE BAG



4X 2656-6493 VAN WALL SHELF ANGLE  
**NOTE ORIENTATION OF SLOTTED HOLES**  
 WILL NEED 50-1/2" INSIDE BETWEEN  
 BRACKETS. DO NOT COMPLETELY TIGHTEN  
 SO THAT BRACKET CAN BE ADJUSTED LEFT  
 TO RIGHT IN FOLLOWING STEPS.

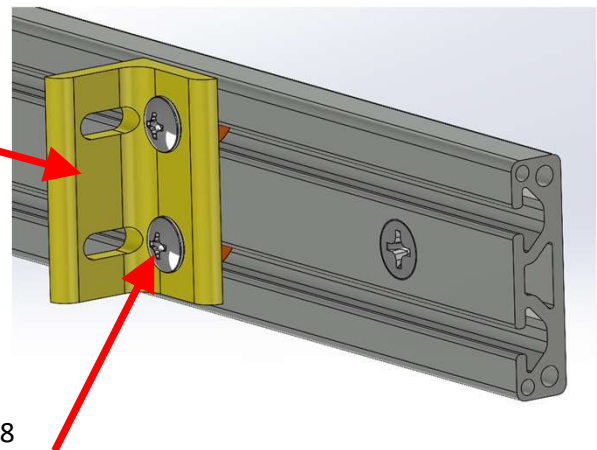

8X 2657-6494 5/16-18 SELF ALIGNING NUT  
 8X 2659-6496 EXTRA WIDE TRUSS HEAD PHILLIPS 5/16-18 X 5/8  
**NOTE: THIS IS THE LONGER SCREW FOR PROPER THREAD  
 ENGAGEMENT, NOT THE SHORTER 1/2**

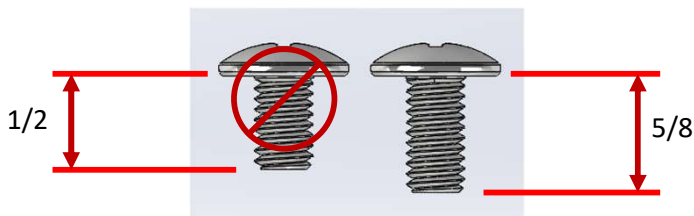

# VW Uprights



THIS HARDWARE BAG



2X 2652-6297 VW SHELF VERTICAL

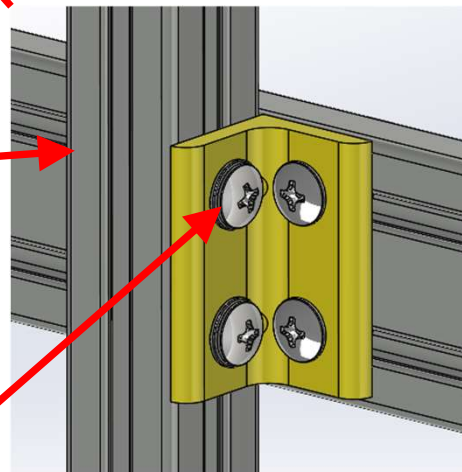

- 8X 2657-6494 5/16-18 SELF ALIGNING NUT
- 8X 1605-2312 WASHER 5/16 FLAT SS
- 8X 2659-6496 EXTRA WIDE TRUSS HEAD PHILLIPS 5/16-18 X 5/8

**NOTE: THIS IS THE LONGER SCREW FOR PROPER THREAD ENGAGEMENT, NOT THE SHORTER 1/2**

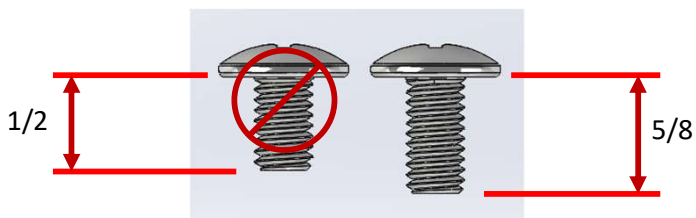



THIS HARDWARE BAG

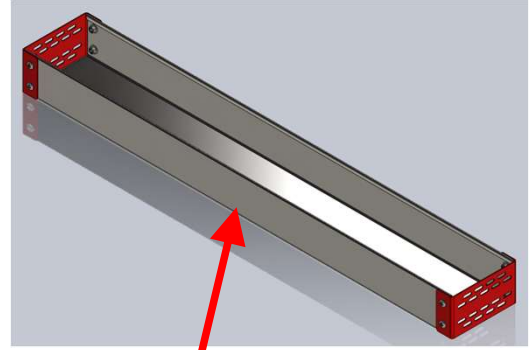

REMOVE PROTECTIVE FILM BEFORE ASSEMBLY

2X 2656-6291 VW SHELF END CAP

8X 1605-2312 5/16 FLAT WASHER  
8X 1604-2311 5/16-18 NYLOC NUT

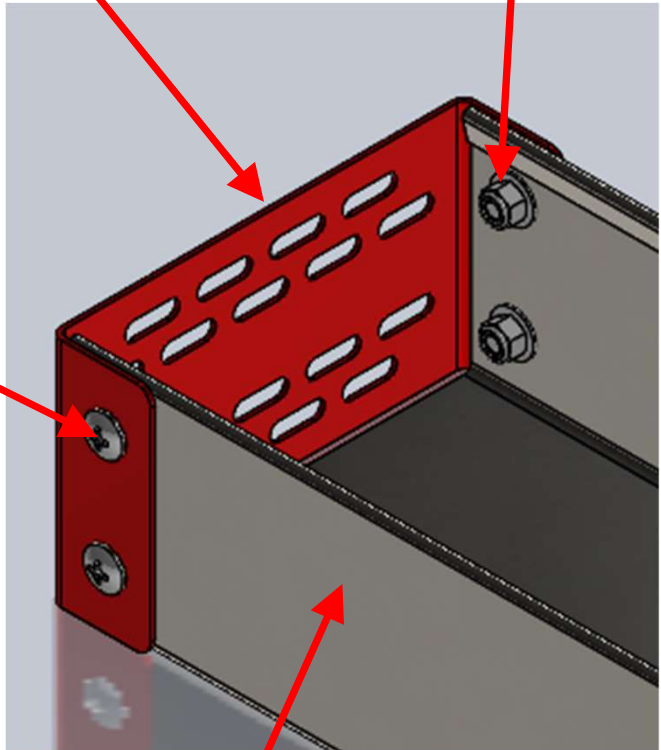

8X 2650-6396 EXTRA WIDE TRUSS  
HEAD PHILLIPS 5/16-18 X 1/2  
**NOTE: THIS IS THE SHORTER SCREW,  
NOT THE LONGER 5/8**

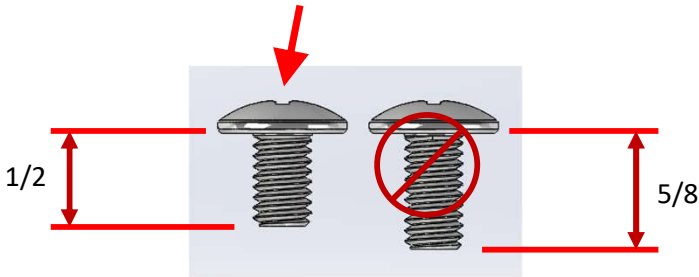

1X 2655-6290 VW SHELF SINGLE

## Insert Nuts for shelves

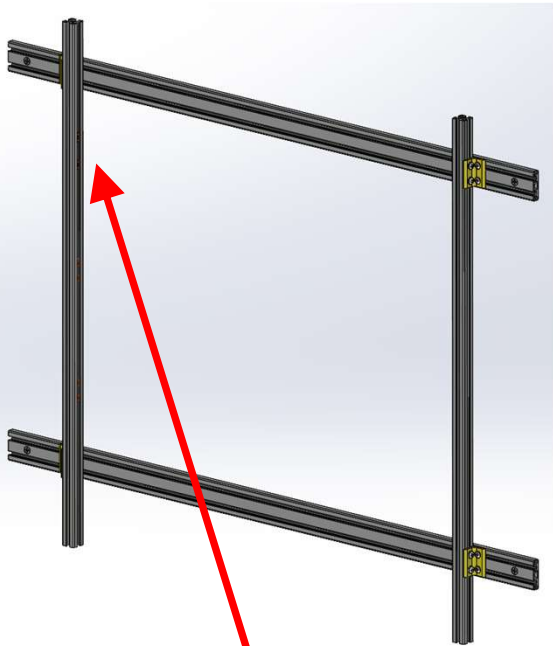

THIS HARDWARE BAG

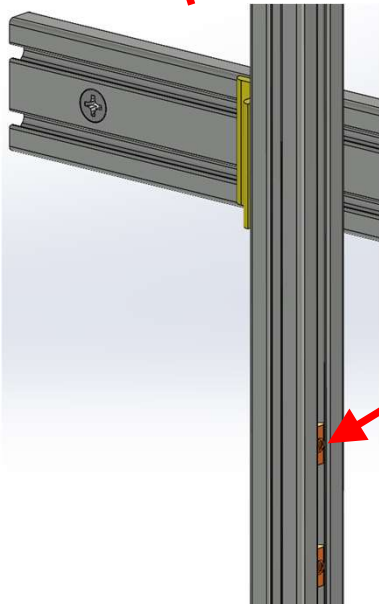

12X 2657-6494 5/16-18 TALL SELF ALIGNING NUT  
INSERT 6 INTO EACH UPRIGHT 2 AT THE HEIGHT OF EACH SHELF



## Determine Shelf Position

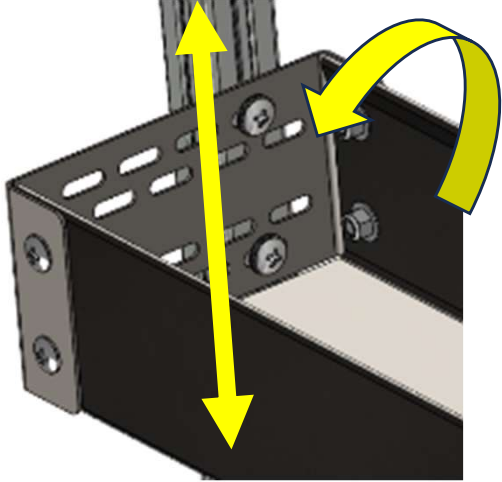

Shelves can be positioned as needed for best efficiency. Height is adjustable up and down on the verticals. Next to the wall or extended out by selecting the desired mounting slots. Leveled or tipped away from the wall as needed. However, do keep the shelves horizontal end to end.

Determine where shelves will be located before attaching shelves.

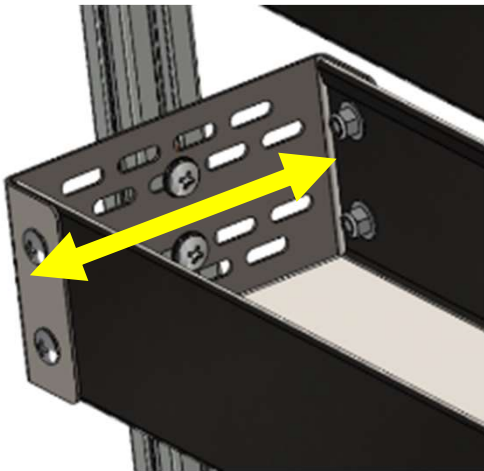

## Attach shelves

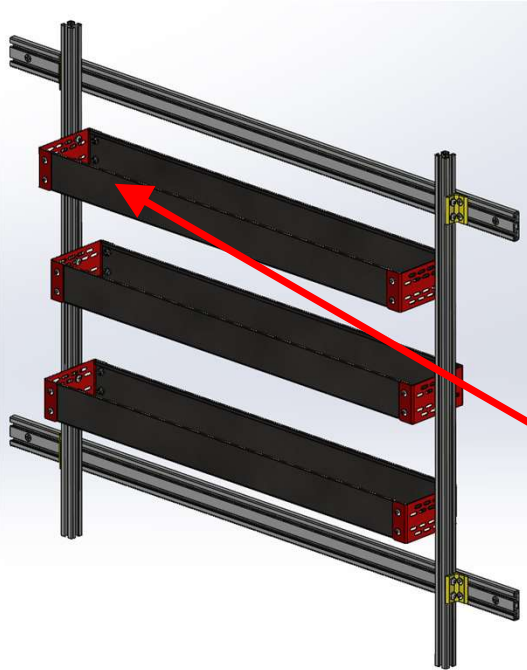

THIS HARDWARE BAG

12X 2650-6396 EXTRA WIDE TRUSS HEAD PHILLIPS 5/16-18 X 1/2  
12X 1605-2312 5/16 FLAT WASHER

At each end of shelf. Choose slots for setting the shelf where desired for space between the wall and shelf.

Set shelves to desired height.

**NOTE: THIS IS THE SHORTER SCREW TO PREVENT BOTTOMING OUT IN THE SLOT, NOT THE LONGER 5/8**

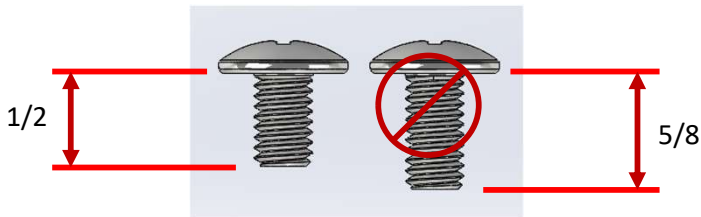
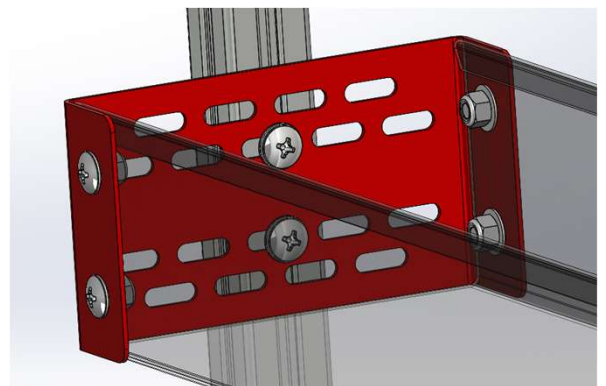
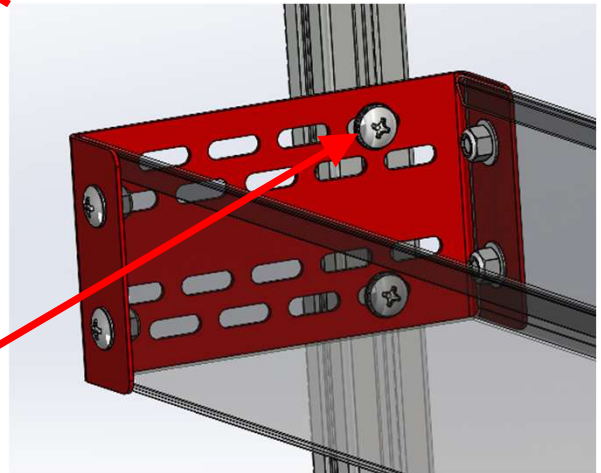

**AFTER SHELVES ARE IN PLACE GO BACK AND SECURELY TIGHTEN ALL FASTENERS.**

# Install caps

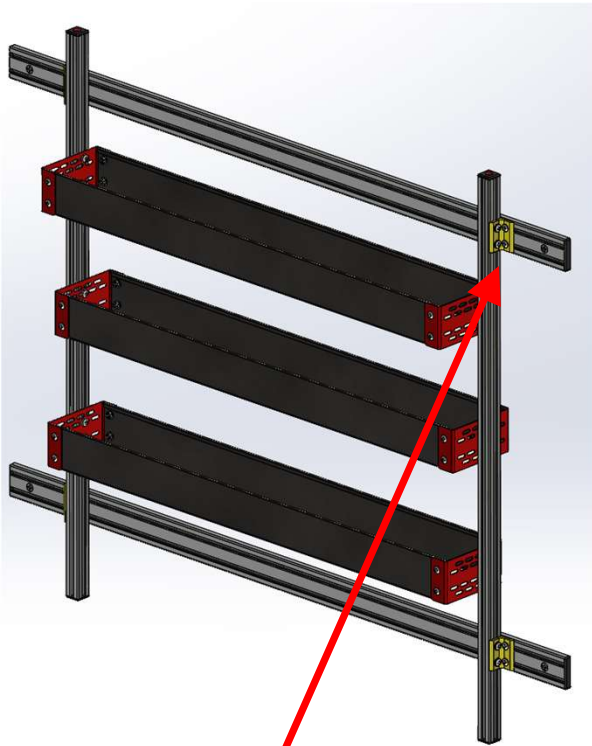

THIS HARDWARE BAG

- 4X 2654-6491 VW 15 SQ CAP
- 4X 2655-6492 VW FASTENER PUSH IN

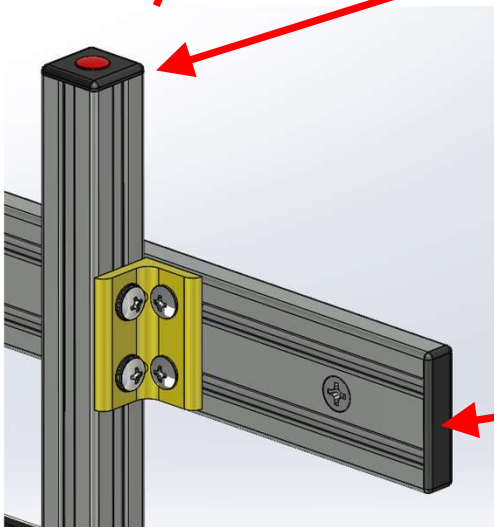

4X 2658-6394 VAN WALL RECTANGULAR CAP